

Polaroid



PSS0417

Selfie Stick Tripod & Ring Light

User Manual

READ CAREFULLY AND SAVE THIS MANUAL

Caution

- **THIS IS NOT A TOY, please keep away from children**
- Do NOT leave charging overnight
- Do NOT submerge in water
- Do NOT expose to water, fire, high temperatures, or humidity
- Do not open this product or attempt to repair the unit yourself should it not be working
- Do NOT store in an enclosed vehicle or area
- Do not disassemble or attempt to repair
- Do not short circuit the battery with any metal objects
- **This device contains a battery, and should NOT be disposed of with regular household waste. Please consult the local authorities on the correct way to dispose of this device**

Technical Specs

- Dimensions: 6.3 x 2.8 x 7.6 - 42 in
- Rechargeable Ring Light Battery: 1200 mAh
- Charging Cable: Micro-USB
- Charging Cable Length: 39 in
- Remote Battery: CR1632
- Weight: 0.7 lb

In the Box

- PSS0417 - **Selfie Stick Tripod & Ring Light** (x1)
- Micro-USB Charging Cable (x1)
- Instruction Manual (x1)

Getting Started

Installing and Removing the Control Panel Box

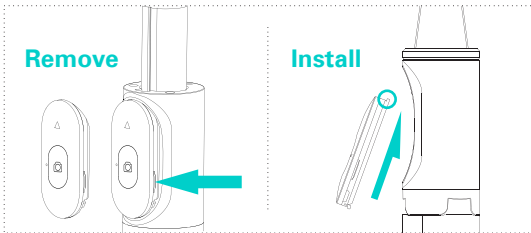

Powering ON/OFF

- Press + hold the camera button for 3 seconds to power ON or OFF.
- When powered ON, the LED indicator will flash for 4 seconds, and the selfie light will enter Bluetooth pairing mode. It may automatically reconnect to a previously paired device.

Note: the selfie light will automatically power OFF after 5 minutes without a Bluetooth connection.



Bluetooth Pairing

1. Power the selfie light ON. The selfie light will enter Bluetooth pairing mode, and the LED indicator will flash BLUE.
2. Turn your device's Bluetooth on, and search for new Bluetooth devices. Select **PSS0417** when it appears on the list of found devices.
3. After a successful pairing, the LED indicator on the selfie light will turn OFF.

Taking a Photo

Power the control panel ON and connect to your device.

- Press the camera button to take a photo. The LED indicator on the control panel will flash BLUE once.

Note: The selfie light will enter standby mode after no photos are snapped for 10 minutes, and will automatically power OFF after 10 minutes in standby mode.



Replacing the Control Panel Battery

1. Remove the control panel box from the selfie light.
2. Using the groove on the corner of the control panel box, open the box.

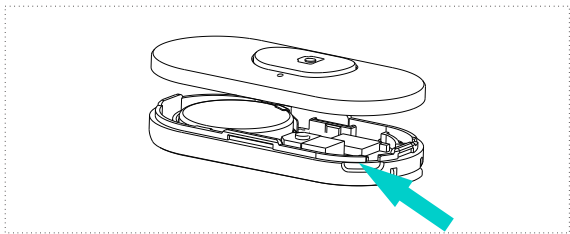

3. Remove the old battery, and dispose of according to local regulations. **Do not dispose of with regular household waste.**
4. Install a new CR1632 battery. Replace the control panel box cover, and install the control panel box back into the selfie light.

Note: Low battery power can cause selfie photography dysfunction. If you notice issues with the selfie stick, try replacing the battery.

Charging the Ring Light

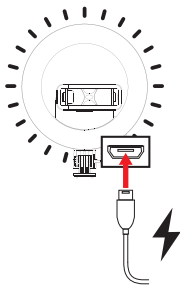

Plug the micro-USB (smaller) connector of the included micro-USB charging cable into the micro-USB port on the ring light.

Plug the USB (larger) connector into a USB power source, such as the USB port on a computer or a 5V USB wall adapter (not included).

Charge for 3 hours before using.

Using the Ring Light

Charge the ring light before using.

- Press + hold the **[Power]** button on the ring light to power ON or OFF.
- Quick press the **[Power]** button to flip through the different light brightness settings.
- When powered OFF, the ring light will remember the last brightness setting it was on.



Unfolding the Tripod

To unfold and adjust the tripod, pull the legs outward where they connect to the selfie stick.

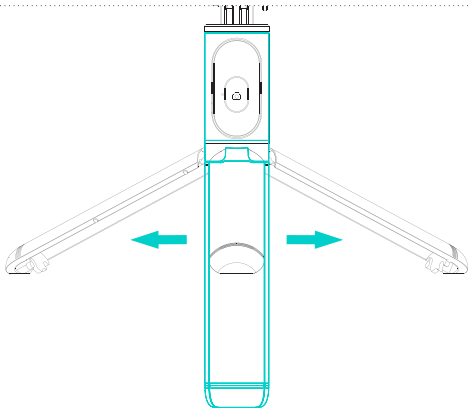

Compliance Information

FCC Information

This device complies with Part 15 of the FCC Rules.

Caution: Any changes or modifications not expressly approved could void the user's authority to operate the equipment.

Note: This equipment has been tested and found to comply with the limits for a Class B digital device, pursuant to part 15 of the FCC Rules. These limits are designed to provide reasonable protection against harmful interference in a residential installation. This equipment generates, uses and can radiate radio frequency energy and, if not installed and used in accordance with the instructions, may cause harmful interference to radio communications. However, there is no guarantee that interference will not occur in a particular installation. If this equipment does cause harmful interference to radio or television reception, which can be determined by turning the equipment off and on, the user is encouraged to try to correct the interference by one or more of the following measures:

- Reorient or relocate the receiving antenna.
- Increase the separation between the equipment and receiver.
- Connect the equipment into an outlet on a circuit different from that to which the receiver is connected.
- Consult the dealer or an experienced radio/TV technician for help.

This device complies with Part 15 of the FCC Rules. Operation is subject to the following two conditions: (1) This device may not cause harmful interference, and (2) this device must accept any interference received, including interference that may cause undesired operation.

This product complies with the requirements for Part 18 of the FCC Rules. Although this product complies with FCC, it may interfere with other devices. If this product is found to interfere with another device, separate the other device and this product.

Radiation Exposure Information

This device has been evaluated to meet general RF exposure requirements. The device can be used in portable exposure conditions without restriction.

WARNING Li-ion Battery Inside

This product is fitted with a Li-ion battery. Do not damage, open, or dismantle the battery and do not use it in damp and/or corrosive conditions. Use only with compatible chargers. Never dispose of batteries in a fire, and never expose them to high temperatures. Do not expose the product to temperatures exceeding 60°C (140°F).



Rating Label Definitions



Direct current symbol.



This symbol signifies that the product must not be discarded as household waste, and should be delivered to an appropriate collection facility for recycling. Proper disposal and recycling helps protect natural resources, human health and the environment.



This symbol signifies and declares that this equipment complies with battery charging which complies with California CEC and energy efficiency.



This symbol represents FCC Declaration of Conformity and compliance.

Warranty Information

90-Day Limited Warranty

Territory: United States/Canada

LIMITED WARRANTY TO ORIGINAL CONSUMER

This product as supplied and distributed new by an authorized retailer is warranted by Southern Telecom, Inc. to the original consumer purchaser against defects in materials and workmanship ("Warranty") as follows:

To obtain warranty service:

- Visit our customer support portal: www.customersupport123.com
- Select the brand and model of your device
- Select "Service Request" and fill out the form to begin your inquiry
- Exchanges require dated proof of purchase from an authorized retailer

Your product will be repaired or replaced, at our option, for the same or similar model of equal value if examination by the service center determines this product is defective. Products received damaged as a result of shipping will require you to file a claim with the carrier.

Warranty service not provided

This warranty does not cover damage resulting from accident, misuse, abuse, improper installation or operation, lack of reasonable care, unauthorized modification including software modifications such as the installation of custom firmware. This warranty is voided in the event any unauthorized person opens, alters or repairs this product. All products being returned to the authorized service center for repair must be suitably packaged.

NO WARRANTIES, WHETHER EXPRESS OR IMPLIED, INCLUDING, BUT NOT LIMITED TO, ANY IMPLIED WARRANTIES OF MERCHANTABILITY OR FITNESS FOR A PARTICULAR PURPOSE, OTHER THAN THOSE EXPRESSLY DESCRIBED ABOVE SHALL APPLY. DISTRIBUTOR FURTHER DISCLAIMS ALL WARRANTIES AFTER THE EXPRESS WARRANTY PERIOD STATED ABOVE. NO OTHER EXPRESS WARRANTY OR GUARANTEE GIVEN BY ANY PERSON, FIRM OR ENTITY WITH RESPECT TO THE PRODUCT SHALL BE BINDING ON DISTRIBUTOR. REPAIR, REPLACEMENT, OR REFUND OF THE ORIGINAL PURCHASE PRICE - AT DISTRIBUTOR'S SOLE DISCRETION - ARE THE EXCLUSIVE REMEDIES OF THE CONSUMER. IN NO EVENT WILL DISTRIBUTOR OR ITS MANUFACTURERS BE LIABLE FOR ANY INCIDENTAL, DIRECT, INDIRECT, SPECIAL, PUNITIVE OR CONSEQUENTIAL DAMAGES (SUCH AS, BUT NOT LIMITED TO, DAMAGES FOR LOSS OF PROFITS, BUSINESS, SAVINGS, DATA OR RECORDS) CAUSED BY THE USE, MISUSE OR INABILITY TO USE THE PRODUCT. EXCEPT AS STATED HEREIN, NO OTHER WARRANTIES SHALL APPLY. NOTWITHSTANDING THE FOREGOING, CONSUMER'S RECOVERY AGAINST DISTRIBUTOR SHALL NOT EXCEED THE PURCHASE PRICE OF THE PRODUCT SOLD BY DISTRIBUTOR. THIS WARRANTY SHALL NOT EXTEND TO ANYONE OTHER THAN THE ORIGINAL CONSUMER WHO PURCHASED THE PRODUCT AND IS NOT TRANSFERABLE.

Some countries, states or provinces do not allow the exclusion or limitation of incidental or consequential damages or allow limitations on warranties, so limitation or exclusions may not apply to you. This warranty gives you specific legal rights, and you may have other rights that vary from state to state or province to province. Contact your authorized retailer to determine if another warranty applies.

All product names, trademarks, and registered trademarks are property of their respective owners. All company, product, and service names used in this document are for identification purposes only. Use of these names, trademarks, and brands does not imply endorsement.

Printed in China
v1. 08-2021

Polaroid



Have questions? We've got answers.

Visit us at customersupport123.com



Instantly recognizable. Instantly reassuring. The Polaroid Classic Border and Polaroid Color Spectrum logos let you know you've purchased a product that exemplifies the best qualities of our brand and that contribute to our rich heritage of quality and innovation.

©2021. All rights reserved.

Polaroid, Polaroid Color Spectrum and Polaroid Classic Border Logo are trademarks of PLR IP Holdings, LLC, used under license. PLR IP Holdings LLC, does not manufacture this product or provide any manufacturer's warranty or support.