

User Manual

PBT3760

(Fold Inward) — — — — ▶

(Back Cover)

(Front Cover)

Using the HDMI (ARC) Input

Plug one connector of an HDMI (ARC) cable (*not included*) into the HDMI (ARC) port on the side of the soundbar. Plug the other connector into the HDMI (ARC) port into the port on your TV or media-playing device.

Press the [M] button to switch to HDMI mode. The LED indicator will light up PURPLE when the soundbar is in HDMI mode.

Controlling Playback & Volume (Bluetooth Only)

- Press the [O/M] button on the soundbar to pause/resume media playback.
- Press and hold the [M+] and [M-] buttons to adjust volume.
- Press the [M+] and [M-] buttons to skip tracks.

Using the Remote Control

- [O] Button: Enter/leave standby mode
- [M] Button: Change input mode
- [M] Button: Pause/resume playback
- [M+] Button: Skip to next track
- [M-] Button: Skip to previous track
- [M] Button: Mute/unmute volume
- [VOL+] Button: Increase volume
- [VOL-] Button: Decrease volume



All product names, trademarks, and registered trademarks are property of their respective owners. All company, product, and service names used in this document are for identification purposes only. Use of these names, trademarks, and brands does not imply endorsement.

Designed in US
Printed in China
v1, 05-2021

Polaroid

Have questions? We've got answers.

Visit us at customersupport123.com



©2021. All rights reserved.

Polaroid, Polaroid Color Spectrum and Polaroid Classic Border Logo are trademarks of PLR IP Holdings, LLC, used under license. PLR IP Holdings LLC, does not manufacture this product or provide any manufacturer's warranty or support.

Polaroid



PBT3760
37" Home Theater Soundbar
User Manual

Before You Begin...

READ CAREFULLY AND KEEP THIS MANUAL

Customer Support

For any questions or problems with your product, please visit our website at customersupport123.com.

Caution

To ensure safe and proper use, read all safety information before using the device. Only use with manufacturer-approved batteries, chargers, accessories, and supplies.

- **THIS DEVICE IS NOT A TOY.** do NOT allow children or pets to use or play with this device.
- **Do not disassemble, modify, or repair the device.**
- Do not expose the device to extreme temperatures (heat or cold), open flames, wet, or humid conditions.
- **Do not submerge in water.**
- Do not allow any ports or connectors of the device or its accessories to be exposed to dust, or water, or come into contact with any conductive materials such as liquids, metallic powders, etc.
- To re-boot the device, please unplug the power adapter and wait at least 5 seconds before plugging back in.

In the Box

- PBT3760 - Wireless Soundbar (x1)
- Wireless Subwoofer (x1)
- Power Adapter (x2)
- AUX-RCA Audio Cable (x1)
- 3.5 mm Auxiliary Cable (x1)
- Remote Control (x1)
- Mounting Screw (x2)
- Instruction Manual (x1)

Location of Controls

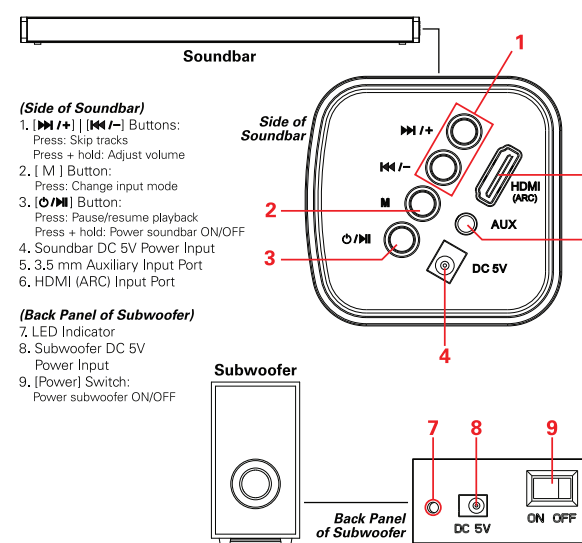

Wall Mounting the Soundbar

1. Remove the speaker and its contents from packaging.
2. Using a pencil, mark two spots on a wall measuring 34.7 inches apart.
3. If installing to a wooden surface, drive or drill a mounting screw into the wall at each marked location. If installing to drywall or a brick surface, you may need to install plastic anchors to properly secure the mounting screws.
4. Place and hang the speaker from its mounting holes on the back onto the installed mounting screws.



Powering the Soundbar and Subwoofer

Insert the pin of one of the supplied power adapters into the DC power input on the side of the soundbar. Plug the adapter into an electrical outlet.

Insert the pin of the other supplied power adapter into the DC power input on the back of the subwoofer. Plug the adapter into an electrical outlet.

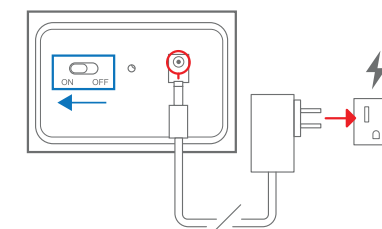

Slide the [Power] switch on the back of the subwoofer to the ON position. When powered on the subwoofer and soundbar will automatically connect to each other.

Getting Started

Powering ON/OFF

- Press and hold the [O/M] button on the soundbar to power ON. A tone will be heard and the soundbar will automatically enter the last mode it was in.
- Press and hold the [O/M] button again to power OFF.

Changing Input Modes

- Press the [M] button to change between Bluetooth, HDMI (ARC) and 3.5 mm AUX audio inputs.

Note: When plugging in a 3.5 mm connector to the speaker, the speaker will automatically switch to AUX mode. If the 3.5 mm cable is plugged in and the speaker is powered ON, the speaker will automatically be in AUX mode.

Bluetooth Pairing

1. Power the soundbar ON and switch to Bluetooth mode by pressing the [M] button. When the speaker is in Bluetooth mode, a tone will be heard and the LED indicator will quickly flash BLUE.
2. Set your mobile device to search for Bluetooth devices. When it appears, select **PBT3760** from the list of found devices.
3. After a successful pairing, a tone will be heard and the LED indicator will slowly flash BLUE.



Using the 3.5 mm AUX Input

To use the speaker as a wired device, insert the 3.5 mm connector of the supplied AUX cable into the 3.5 mm auxiliary audio input jack on the side of the soundbar. Insert the RCA connectors into the audio outputs of your media-playing device.

Note: Typically, RCA connectors are color-coded with red being for the right audio channel and white being for the left audio channel.

The LED indicator will turn RED when the AUX input is in use. While connected, playback is controlled via the connected device. Volume can be controlled with the speaker, remote control or the connected device.