

Compliance Information

FCC Information

This device complies with Part 15 of the FCC Rules.

Caution: Any changes or modifications not expressly approved could void the user's authority to operate the equipment.

Note: This equipment has been tested and found to comply with the limits for a Class B digital device, pursuant to part 15 of the FCC Rules. These limits are designed to provide reasonable protection against harmful interference in a residential installation. This equipment generates, uses and can radiate radio frequency energy and, if not installed and used in accordance with the instructions, may cause harmful interference to radio communications. However, there is no guarantee that interference will not occur in a particular installation. If this equipment does cause harmful interference to radio or television reception, which can be determined by turning the equipment off and on, the user is encouraged to try to correct the interference by one or more of the following measures:

- Reorient or relocate the receiving antenna.
- Increase the separation between the equipment and receiver.
- Connect the equipment into an outlet on a circuit different from that to which the receiver is connected.
- Consult the dealer or an experienced radio/TV technician for help.

This device complies with Part 15 of the FCC Rules. Operation is subject to the following two conditions: (1) This device may not cause harmful interference, and (2) this device must accept any interference received, including interference that may cause undesired operation.

WARNING Li-ion Battery Inside

This product is fitted with a Li-ion battery. Do not damage, open, or dismantle the battery and do not use it in damp and/or corrosive conditions. Use only with compatible chargers. Never dispose of batteries in a fire, and never expose them to high temperatures. Do not expose the product to temperatures exceeding 60°C (140°F).



Rating Label Definitions



This symbol signifies that the product must not be discarded as household waste, and should be delivered to an appropriate collection facility for recycling. Proper disposal and recycling helps protect natural resources, human health and the environment.



This symbol signifies and declares that this equipment complies with battery charging which complies with California CEC and energy efficiency.



Direct current symbol.



This symbol represents FCC Declaration of Conformity and compliance.

TRACKING CODE:
SO020020



Distributed by: 1616 Holdings, Inc.
701 Market Street, Suite 200
Philadelphia, PA 19106

MADE IN CHINA A20

All product names, trademarks, and registered trademarks are property of their respective owners. All company, product, and service names used in this document are for identification purposes only. Use of these names, trademarks, and brands does not imply endorsement.

Printed in China
v1.02-2020

TRAXX

2,600 mAh Power Bank

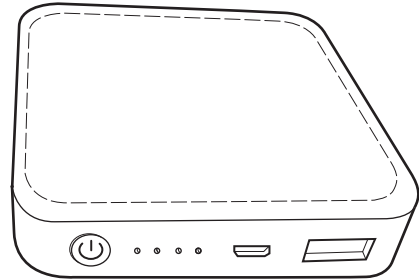

Instruction Manual
- TX2600CLR-FB -

Before You Begin...

READ CAREFULLY AND SAVE THIS MANUAL

Caution

- **THIS IS NOT A TOY, please keep away from children**
- Do NOT leave charging overnight
- Do NOT submerge in water
- Do NOT expose to water, fire, high temperatures, or humidity
- Do not open this product or attempt to repair the unit yourself should it not be working
- Do NOT store power bank in an enclosed vehicle or area
- Do not disassemble or attempt to repair
- Do not short circuit the battery with any metal objects

Technical Specs

- Battery: Li-ion battery
- Input: 5V-1A (max)
- Output: 5V-1A (max)
- Capacity: 2,600 mAh

In the Box

- TX2600CLR-FB - **Power Bank** (x1)
- USB Charging Cable (x1)
- Instruction Manual (x1)

Location of Controls

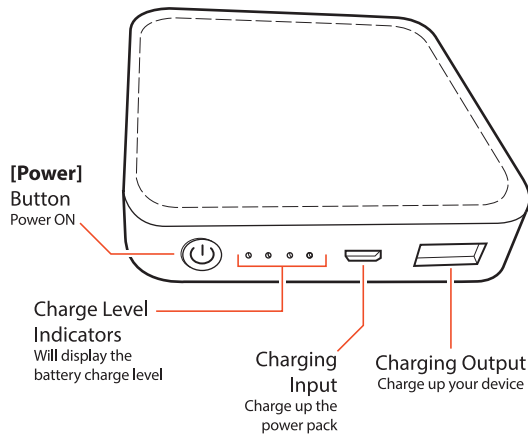

Getting Started

Charging the Power Bank

Insert the small connector of the supplied USB cable into the charging input port on the end of the power bank. Insert the large connector into the USB port on a computer or a **5V USB adapter** (*not included*) and plug into a wall socket. The power pack will be fully charged after 2-3 hours.

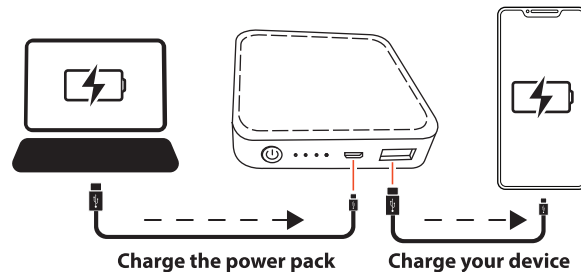

NOTE: Make sure the power bank is fully charged before using.

Charging Your Device

Insert the large connector of the supplied USB cable into the output port on the power bank. Insert the small connector into the charging port on your device.