



**PBGM1003**

## **ARSENAL 4-in-1 Pro Gaming Kit**

Instruction Manual



# Before You Begin

## In the Box

- Gaming Speakers (x2)
- Gaming Keyboard (x1)
- Gaming Mouse (x1)
- LED Light Strip (x1)
- Light Strip Remote Control (x1)
- User Manual (x1)

## Caution

To ensure safe and proper use, read all safety information before using the devices. Only use with manufacturer-approved batteries, chargers, accessories, and supplies.

- **THIS DEVICE IS NOT A TOY**, do NOT allow children or pets to use or play with these devices.
- **Do not disassemble, modify, or repair the devices.**
- *Do not submerge in water.*
- Do not expose the units to extreme temperatures (heat or cold), open flames, humid, or wet conditions.
- Do not allow the USB ports, power jack or other inputs of the devices to be exposed to dust, or water, or come into contact with any conductive materials such as liquids, metallic powders, etc.



PBX® is a registered trademark of PBX® Holdings, LLC.

All product names, trademarks, and registered trademarks are property of their respective owners. All company, product, and service names used in this document are for identification purposes only. Use of these names, trademarks, and brands does not imply endorsement.

## Using the Mouse and Keyboard

### Mouse and Keyboard Setup

Plug the keyboard and mouse's attached USB connectors into any of the USB ports (Type-A) on the front or back of your computer.

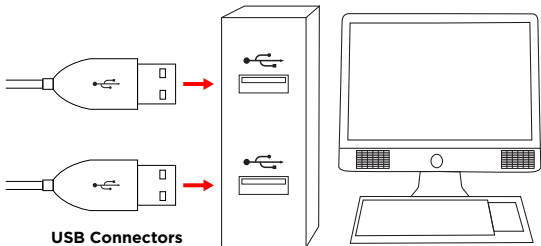

The keyboard and mouse do not require any special installation or software. Your computer should automatically detect and install them.

If your computer does not automatically connect to the keyboard or mouse, try restarting your computer or checking the devices settings in your computer's **Settings** or **System Preferences** panel.

## Using the Speakers

### Speakers Setup

Plug the speakers' attached 3.5 mm connector into the 3.5 mm audio output port on your computer or media-playing device.

Plug the speakers' attached USB connector into any USB port (Type-A) on your computer, or into a compatible **5V USB adapter** (not included) and plug into a wall socket.

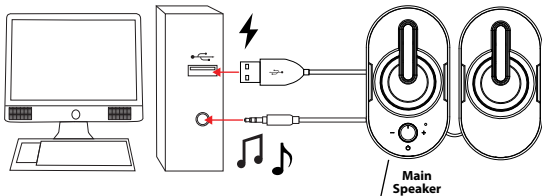

### Using the Speakers

Turn the **[Power]** dial on the front of the main speaker to power ON and OFF, and to adjust volume. When powered ON, the speaker lights will turn on and the LED indicator will **turn solid BLUE**.

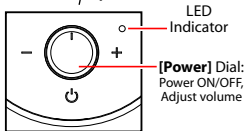

Audio playback will be controlled with the controls on your computer or connected device.

# Using the LED Lightstrip

## Lightstrip Setup

Select a location for the lightstrip near a power source such as the USB port on a computer or a compatible **5V USB adapter** (*not included*).

## Placement Example: Back of Computer Screen

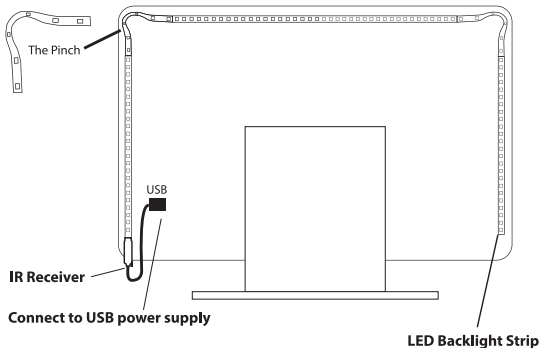

## Using the LED Lightstrip (cont'd)

### Lightstrip Setup (cont'd)

If necessary, you can cut the lightstrip to shorten it. Using a pair of scissors, cut along one of the marked lines on the side away from the pin head side of the lightstrip, as shown in the diagram below.

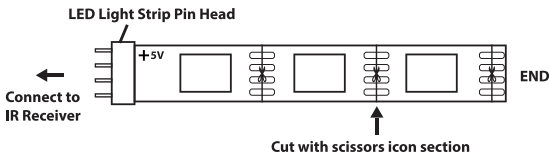

Connect the lightstrip to the IR receiver, as shown below:

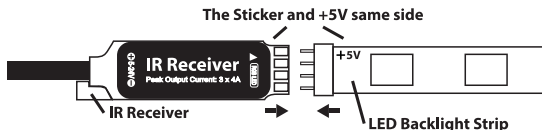

For best results, place the lightstrip's IR receiver within clear view of the where the lightstrip remote control will be used, and away from any other IR receiver such as on a computer or television.

## Using the LED Lightstrip (cont'd)

### Lightstrip Setup (cont'd)

Once you have the lightstrip set up in the desired position and connected to a power source, peel the backing off the lightstrip's adhesive and press firmly onto the desired surface.

### Using the LED Lightstrip

Remove the battery tab from the included remote control, and use the remote control to power the lightstrip ON/OFF and adjust the color, brightness and light mode of the lightstrip.

- For a solid color, select **[RED]**, **[GREEN]**, **[BLUE]**, **[ORANGE]**, **[YELLOW]**, **[CYAN]** or **[PURPLE]**.
- For a dynamic light mode, press a **[JUMP]** or **[FADE]** button.
- For a sound-responsive mode, press a **[♪]** button.

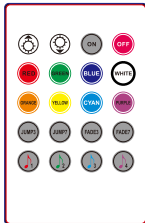

### Replacing the Remote Control Battery

1. Remove the battery cover on the bottom of the remote control, as shown at right.
2. Remove the old battery and place a new CR2025 battery (*not included*) in the tray.
3. Replace the battery cover.

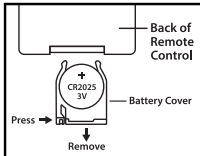

### Keyboard Tech Specs

Keys: 104

Lifespan: 3 million keystrokes

Interface: USB 2.0

Cable length: 1.4 m

Size: 450 x 172 x 25 mm

Rated voltage: 5 V

Rated current: 100 mA

### Mouse Tech Specs

DPI: 1000

Lifespan: 1 million clicks

Backlight: 7 colors

Interface: USB 2.0

Cable length: 1.5 m

Size: 118 x 68 x 33 mm

Rated voltage: 5 V

Rated current: 100 mA

### LED Strip Lights Tech Specs

Power: 5 V

Length: 2 m / 6.6 ft

LEDs: 60

LED Modes: 16

### Rating Label Definitions



Direct current symbol.



This symbol represents FCC Declaration of Conformity and compliance.



The European Conformity (Conformité Européene) symbol signifies that the product has been assessed to meet the safety, health, and environmental protection standards required by European Union law for trade in the European Economic Area (EEA).



# Compliance Information

## FCC Information

This device complies with Part 15 of the FCC Rules.

**Caution:** Any changes or modifications not expressly approved could void the user's authority to operate the equipment.

**Note:** This equipment has been tested and found to comply with the limits for a Class B digital device, pursuant to part 15 of the FCC Rules. These limits are designed to provide reasonable protection against harmful interference in a residential installation. This equipment generates, uses and can radiate radio frequency energy and, if not installed and used in accordance with the instructions, may cause harmful interference to radio communications. However, there is no guarantee that interference will not occur in a particular installation. If this equipment does cause harmful interference to radio or television reception, which can be determined by turning the equipment off and on, the user is encouraged to try to correct the interference by one or more of the following measures:

- Reorient or relocate the receiving antenna.
- Increase the separation between the equipment and receiver.
- Connect the equipment into an outlet on a circuit different from that to which the receiver is connected.
- Consult the dealer or an experienced radio/TV technician for help.

This device complies with Part 15 of the FCC Rules. Operation is subject to the following two conditions: (1) This device may not cause harmful interference, and (2) this device must accept any interference received, including interference that may cause undesired operation.

## Radiation Exposure Information

This device has been evaluated to meet general RF exposure requirements. The device can be used in portable exposure conditions without restriction.

## **6-Month Limited Warranty**

**For technical service on this product,  
please contact:**



Servicio al Cliente  
Fono: 02-23410466  
Av. Italia 1729, Ñuñoa  
[info@sgservicios.cl](mailto:info@sgservicios.cl)  
[www.sgservicios.cl](http://www.sgservicios.cl)