

# LOMI

AROMA FAN  
DIFFUSER



User Guide  
LOMD1100

## Before You Begin...

### **READ FULL MANUAL BEFORE USING & SAVE FOR FUTURE REFERENCE**

#### NOT Intended for Medical Use

This product is designed as a non-professional device for relaxation. **It is not intended to be a substitute for medical attention.** If your ailments persist or worsen after use, contact your doctor immediately.

Please consult your doctor prior to using this product, if you have any concerns regarding your health.

**Included essential oils are for diffuser use only. Do NOT ingest essential oils.**

#### Caution

- **THIS IS NOT A TOY, please keep away from children.**
- **Do not submerge in water.**
- **Never use in or near a bathtub, pool or body of water. Never use the diffuser where it could fall into a body of water.**
- Keep away from open flames, water, moisture, and extreme heat or cold.
- Supervision is recommended when this appliance is used by individuals with certain disabilities.
- Use this appliance only for its intended use as described in this manual. DO NOT use attachments not recommended by the manufacturer.
- Never operate this appliance if it is not working properly or if it has been dropped or damaged.
- Keep the appliance away from heated surfaces.
- Do not open this product or attempt to repair the unit yourself. There are no user-serviceable parts.

#### In the Box

- Aroma Diffuser (x1)
- Power Cable (x1)
- Cotton Wicks (x3)
- 5 mL Bottle Essential Oil (x3)
- Instruction Manual (x1)

# Using the Diffuser

## Location of Controls

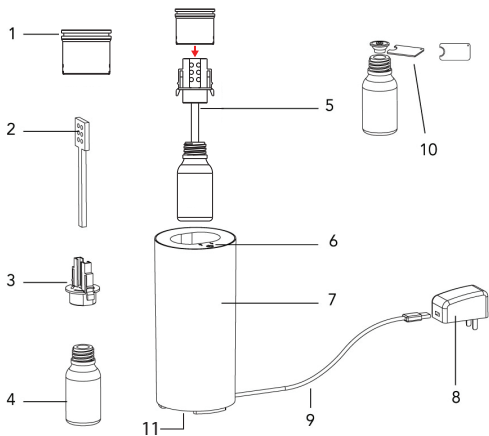

1. Top Cover
2. Wick
3. Wick Holder
4. Essential Oil Bottle
5. Cover Assembly
6. Power Button
7. Diffuser Base
8. USB Wall Adapter (not included)
9. USB Power Cord
10. Bottle Dropper Remover
11. Power Input Port

## Connecting to Power

Plug the round pin of the included power cable into the power input port on the bottom of the diffuser.

Plug the USB connector into a USB power source, such as a 5V/1A USB wall adapter (*not included*).

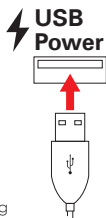

## Setting Up

1. Remove the cover assembly by gently pulling up on the top.
2. Remove the wick holder by pressing the two tabs on the wick holder in, while compressing the front and back on the cover assembly together.
3. Insert the wick into the wick holder underneath the cover assembly.
4. Pour your favorite essential oil into the supplied glass bottle, or remove the lid from a 10 or 15 mL standard essential oil bottle. Insert the wick into the bottle. Gently twist clockwise onto the bottom of the cover assembly. If your bottle has a plastic dropper cap, this will need to be removed using the bottle dropper remover before placing the wick inside.
5. Once the essential oil bottle is secured to the cover assembly, gently place into the diffuser base.
6. Connect to power, as described above.

## Powering ON/OFF

- Press the Power button. The diffuser will power ON on High Setting.
- Press the Power button a 2nd time to enter LOW setting.
- Press the Power button a 3rd time to power OFF.

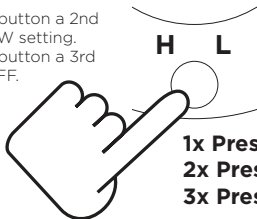

**1x Press:** High  
**2x Press:** Low  
**3x Press:** OFF



## After Use

Disconnect from power after using. Remove the essential oil from the diffuser, or store upright. Store in a cool, dry location.

## Maintenance

Always turn off and unplug the diffuser before doing maintenance.

- Clean the wick, or use a new wick, when switching to a new scent of essential oil. The wick can be cleaned by cleaning the glass bottle, filling with water, and running the diffuser for a few hours.
- Use a soft damp or dry cloth to gently wipe the diffuser.
- Do not use alcohol or any corrosive cleaning agents on the diffuser.

# LOMI

# Safety Warnings

## Warning

- **THIS IS NOT A TOY**, Please keep away from children and pets.
- Follow all instructions. Heed all warnings.
- For indoor use only.
- Only use with manufacturer-approved accessories, and supplies.
- Do not expose the unit to extreme temperatures (heat or cold), open flames, humid conditions, or wet conditions.
- Keep away from rain and moisture. Do not submerge in water.
- Never operate or handle the product or plug with wet hands.
- Clean only with a dry cloth.
- Do not block any ventilation openings. Install in accordance with the manufacturer's instructions.
- Do not install near any heat sources such as radiators, heat registers, stoves, or other apparatus (including amplifiers) that produce heat.
- Protect the power cord from being walked on or pinched particularly at plugs convenience receptacles, and the point where they exit from the apparatus.
- Unplug during lightning storms or when unused for long periods of time.
- Do not open or attempt to repair the unit yourself should it not be working.
- Refer all servicing to qualified service personnel. Servicing is required when the apparatus has been damaged in any way, such as power-supply cord or plug is damaged or wires are exposed; liquid has been spilled or objects have fallen into the apparatus; the apparatus has been exposed to rain or moisture, does not operate normally, or has been dropped.
- **WARNING:** The mains plug is used as a disconnect device; the disconnect device shall remain readily operable.
- **WARNING:** To reduce the risk of fire or electric shock, do not expose this apparatus to rain or moisture. The apparatus shall not be exposed to dripping or splashing, and objects filled with liquids, such as vases, shall not be placed on apparatus.

## Caution

- Do not use appliance for other than intended use.
- Do not operate unattended.
- Do NOT put fingers or hands into the product.
- Keep out of reach of children and pets. Children should not be left unsupervised near this product. This unit is not to be used by children or any person(s) with reduced physical, sensory, or mental capabilities, or lack of experience and knowledge unless they have been given express supervision and instruction.

## Additional Precautions and Warnings

- The output power taken from the supply must not exceed the rating given on the power supply.
- Always turn off and unplug when not in use or before maintenance.
- Keep away from direct sunlight, heat sources, air conditioners, and fans.
- Always keep on a stable, flat surface. Do NOT place on a carpet, bed, cushion or other non-flat, non-stable surface.
- Keep away from electronic equipment.
- Do not use for more than 2 hours at a time.
- Never move the product while in use.
- Keep the power cable clear of pathways, and do not forcefully pull or remove from the unit.
- To disconnect, grip plug and pull from wall outlet. Never pull on cord to disconnect.
- If smoke or burning smell is detected, immediately unplug the unit.
- Do not use outdoors.

# Compliance Information

## FCC Information

This device complies with Part 15 of the FCC Rules.

**Caution:** Any changes or modifications not expressly approved could void the user's authority to operate the equipment.

**Note:** This equipment has been tested and found to comply with the limits for a Class B digital device, pursuant to part 15 of the FCC Rules. These limits are designed to provide reasonable protection against harmful interference in a residential installation. This equipment generates, uses and can radiate radio frequency energy and, if not installed and used in accordance with the instructions, may cause harmful interference to radio communications. However, there is no guarantee that interference will not occur in a particular installation. If this equipment does cause harmful interference to radio or television reception, which can be determined by turning the equipment off and on, the user is encouraged to try to correct the interference by one or more of the following measures:

- Reorient or relocate the receiving antenna.
- Increase the separation between the equipment and receiver.
- Connect the equipment into an outlet on a circuit different from that to which the receiver is connected.
- Consult the dealer or an experienced radio/TV technician for help.

This device complies with Part 15 of the FCC Rules. Operation is subject to the following two conditions: (1) This device may not cause harmful interference, and (2) this device must accept any interference received, including interference that may cause undesired operation.

## Radiation Exposure Information

This device has been evaluated to meet general RF exposure requirements. The device can be used in portable exposure conditions without restriction.

## Rating Label Definitions



Direct current symbol.



This symbol represents FCC Declaration of Conformity and compliance.

# Warranty Information

## 90-Day Limited Warranty

Territory: United States/Canada

### LIMITED WARRANTY TO ORIGINAL CONSUMER

This product as supplied and distributed new by an authorized retailer is warranted by Southern Telecom, Inc. to the original consumer purchaser against defects in materials and workmanship ("Warranty") as follows:

#### To obtain warranty service:

- Visit our customer support portal: [www.customersupport123.com](http://www.customersupport123.com)
- Select the brand and model of your device
- Select "Service Request" and fill out the form to begin your inquiry
- Exchanges require dated proof of purchase from an authorized retailer

Your product will be repaired or replaced, at our option, for the same or similar model of equal value if examination by the service center determines this product is defective. Products received damaged as a result of shipping will require you to file a claim with the carrier.

#### Warranty service not provided

This warranty does not cover damage resulting from accident, misuse, abuse, improper installation or operation, lack of reasonable care, unauthorized modification including software modifications such as the installation of custom firmware. This warranty is voided in the event any unauthorized person opens, alters or repairs this product. All products being returned to the authorized service center for repair must be suitably packaged.

NO WARRANTIES, WHETHER EXPRESS OR IMPLIED, INCLUDING, BUT NOT LIMITED TO, ANY IMPLIED WARRANTIES OF MERCHANTABILITY OR FITNESS FOR A PARTICULAR PURPOSE, OTHER THAN THOSE EXPRESSLY DESCRIBED ABOVE SHALL APPLY. DISTRIBUTOR FURTHER DISCLAIMS ALL WARRANTIES AFTER THE EXPRESS WARRANTY PERIOD STATED ABOVE. NO OTHER EXPRESS WARRANTY OR GUARANTY GIVEN BY ANY PERSON, FIRM OR ENTITY WITH RESPECT TO THE PRODUCT SHALL BE BINDING ON DISTRIBUTOR. REPAIR, REPLACEMENT, OR REFUND OF THE ORIGINAL PURCHASE PRICE - AT DISTRIBUTOR'S SOLE DISCRETION - ARE THE EXCLUSIVE REMEDIES OF THE CONSUMER. IN NO EVENT WILL DISTRIBUTOR OR ITS MANUFACTURERS BE LIABLE FOR ANY INCIDENTAL, DIRECT, INDIRECT, SPECIAL, PUNITIVE OR CONSEQUENTIAL DAMAGES (SUCH AS, BUT NOT LIMITED TO, DAMAGES FOR LOSS OF PROFITS, BUSINESS, SAVINGS, DATA OR RECORDS) CAUSED BY THE USE, MISUSE OR INABILITY TO USE THE PRODUCT. EXCEPT AS STATED HEREIN, NO OTHER WARRANTIES SHALL APPLY. NOTWITHSTANDING THE FOREGOING, CONSUMER'S RECOVERY AGAINST DISTRIBUTOR SHALL NOT EXCEED THE PURCHASE PRICE OF THE PRODUCT SOLD BY DISTRIBUTOR. THIS WARRANTY SHALL NOT EXTEND TO ANYONE OTHER THAN THE ORIGINAL CONSUMER WHO PURCHASED THE PRODUCT AND IS NOT TRANSFERABLE.

Some countries, states or provinces do not allow the exclusion or limitation of incidental or consequential damages or allow limitations on warranties, so limitation or exclusions may not apply to you. This warranty gives you specific legal rights, and you may have other rights that vary from state to state or province to province. Contact your authorized retailer to determine if another warranty applies.

All product names, trademarks, and registered trademarks are property of their respective owners. All company, product, and service names used in this document are for identification purposes only. Use of these names, trademarks, and brands does not imply endorsement.