

# Brookstone®

---

## BIG BLUE GO

COMPACT WIRELESS SPEAKER



BKS380

## IN THE BOX

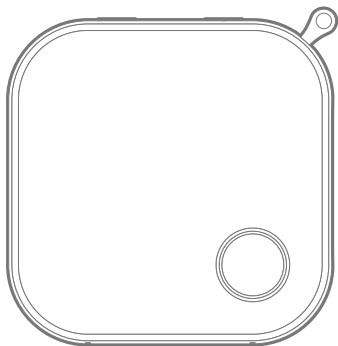

Wireless Speaker

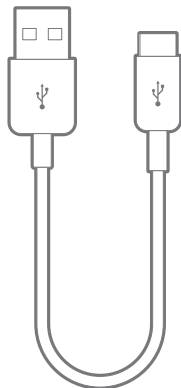

USB Type-C Cable

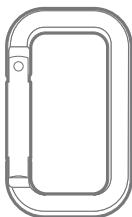

Carabiner



User Guide

# LOCATION OF CONTROLS

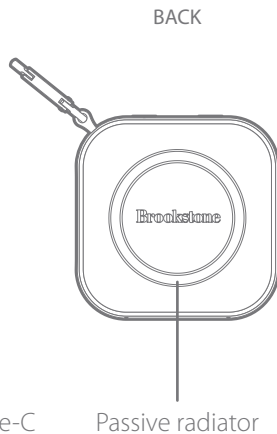
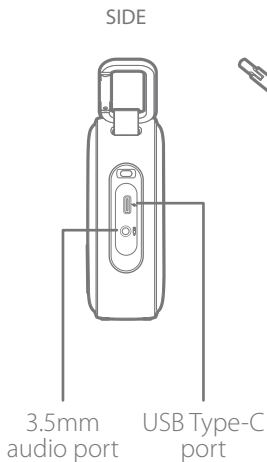
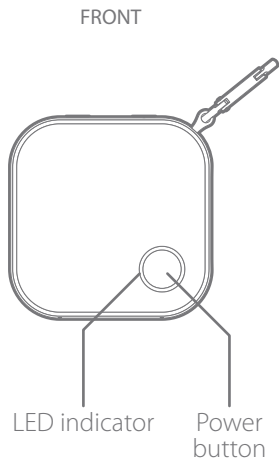
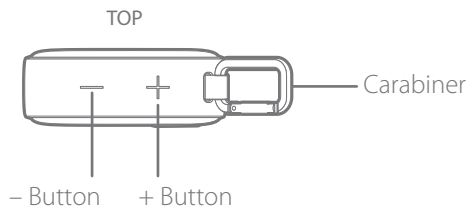

## CHARGING

Insert the USB Type-C cable into the speaker's USB port as shown below and connect the other end to any USB adapter or charging device. The LED will light up **RED** while charging and turn off when fully charged.

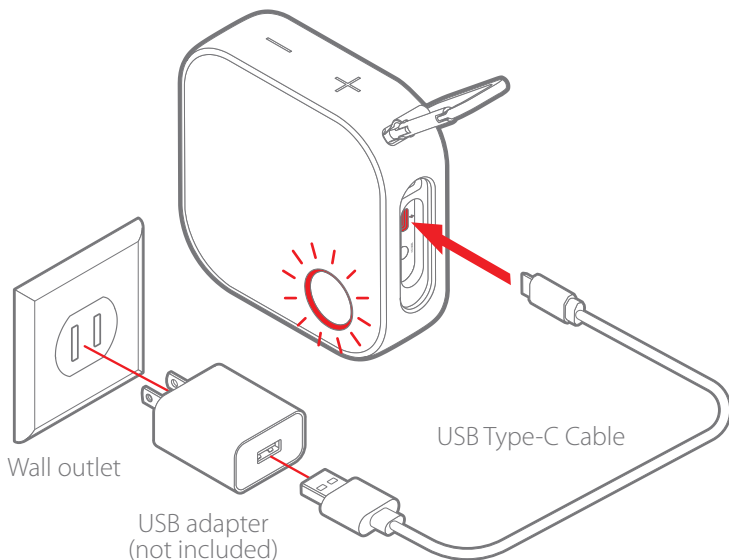

**Note:** When the battery is low the "Battery Low " prompt is heard and the **RED** LED will flash once every 10 seconds.

## POWER BUTTON

The Power button is used to power the speaker on or off, play/pause your music, or answer an incoming call.

The Power button is touch-controlled. Gently touch it instead of pressing down:

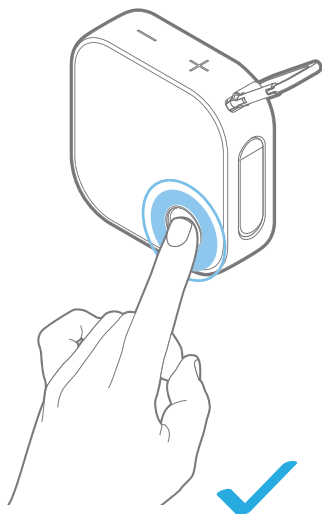

Correct  
Gently touch the Power button

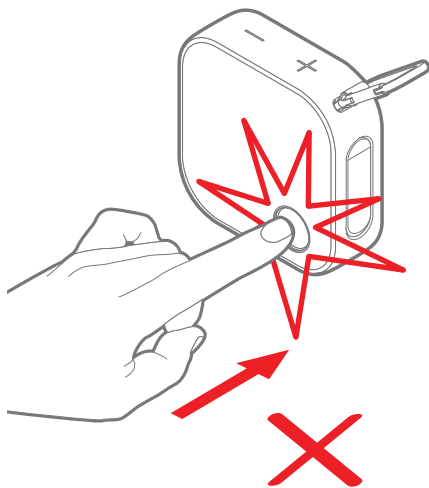

Incorrect  
Don't push down on  
the Power button

## POWER ON/OFF

### Power on

Touch and **HOLD** the Power button for 2 seconds until the speaker powers on.

### Power off

Touch and **HOLD** the Power button until the **BLUE** LED light turns off.

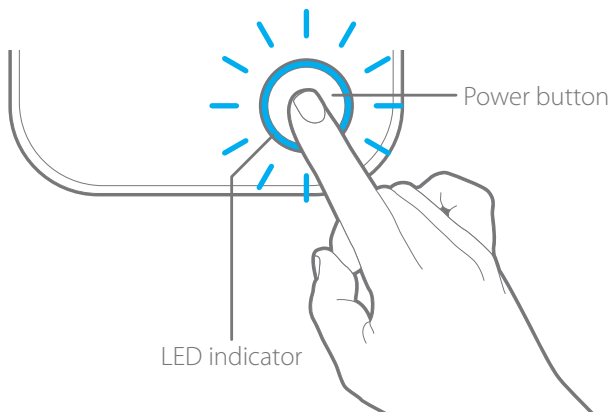

### Note:

1. The speaker will automatically power off after 15 minutes when it's not connected to a device.
2. The speaker will automatically power off after 30 minutes of inactivity.

## BLUETOOTH PAIRING

### Connecting

1. When the speaker is powered on for the first time *or* not connected to a device, it will be in pairing mode, and the LED will flash **BLUE**.

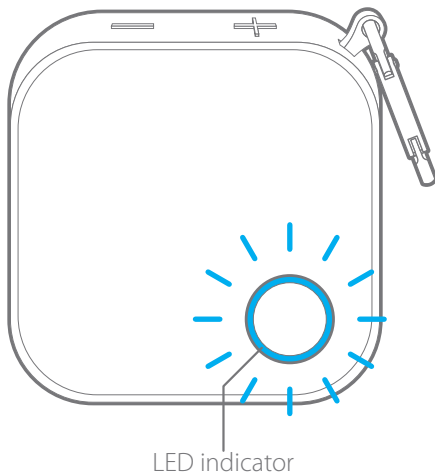

2. Open your device's Bluetooth menu and find **BKS380** and select it to pair.



3. Once paired, "Connected" will be heard and the LED will turn solid **BLUE**.



## Disconnecting

Press and **HOLD** the “+” and “-” buttons for 3 seconds to disconnect the speaker from a device. Once it disconnects, you’ll hear “Disconnected” and it will go into pairing mode.

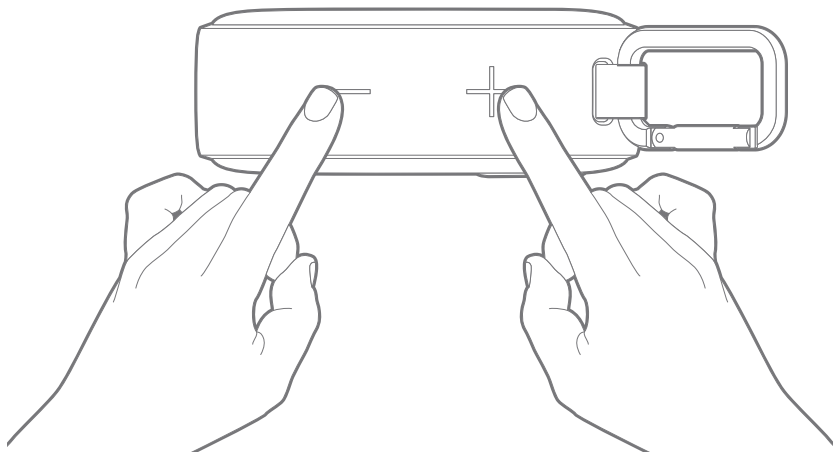

**Note:** This feature is handy to quickly pair the speaker to a new device.

## LINKING TWO SPEAKERS

You can link two Brookstone Big Blue Go speakers to create a TWS (true wireless) pairing. Before beginning the linking process, make sure that only one of the speakers (not both speakers) is paired and connected to a Bluetooth enabled device (see page 6). We will refer to that speaker as **Speaker 1** (main speaker) and the other speaker as **Speaker 2**.

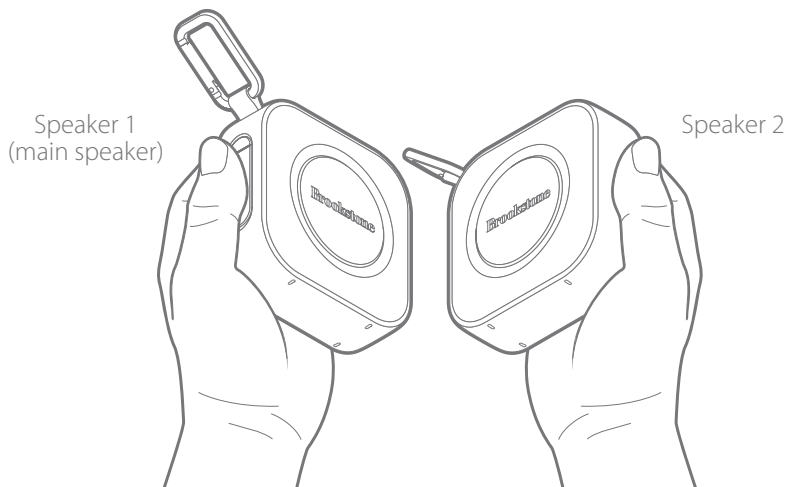

1. Place the two speakers together, back to back, as shown below until you hear the "Linking" voice prompt and the LED indicator of **Speaker 2** starts quickly flashing **BLUE**.

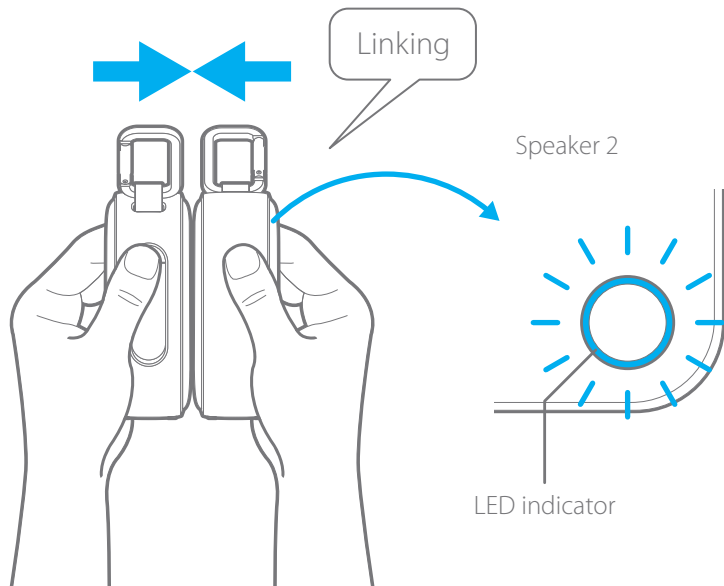

2. Once the speakers are linked, you'll hear the "Speaker Linked" voice prompt and the LED indicator of **Speaker 1** (main speaker) will be solid **BLUE** while **Speaker 2** will slowly flash **BLUE**.

Speaker 1

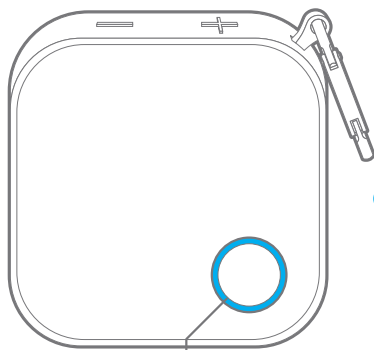

LED indicator



Speaker 2

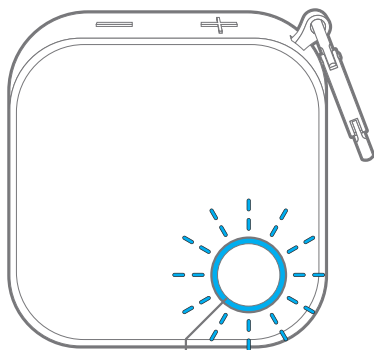

LED indicator

## Unlinking the speakers

Place the two speakers together, back to back, as shown below until you hear the "Unlinked" voice prompt. The LED indicator of **Speaker 1** will remain solid **BLUE** while **Speaker 2** will flash **BLUE** and enter Bluetooth pairing mode.

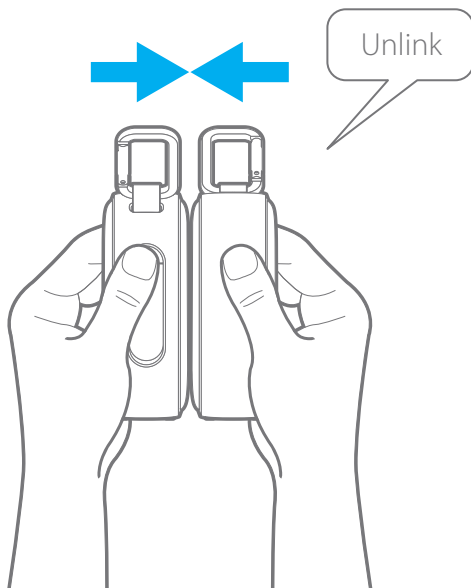

## Disconnecting a device from the linked speakers

Press and **HOLD** the "+" and "-" buttons for 3 seconds of either speaker and you will hear the voice prompt "Disconnected". The LED indicator of Speaker 1 will flash **BLUE**. You can now connect that speaker to another device.

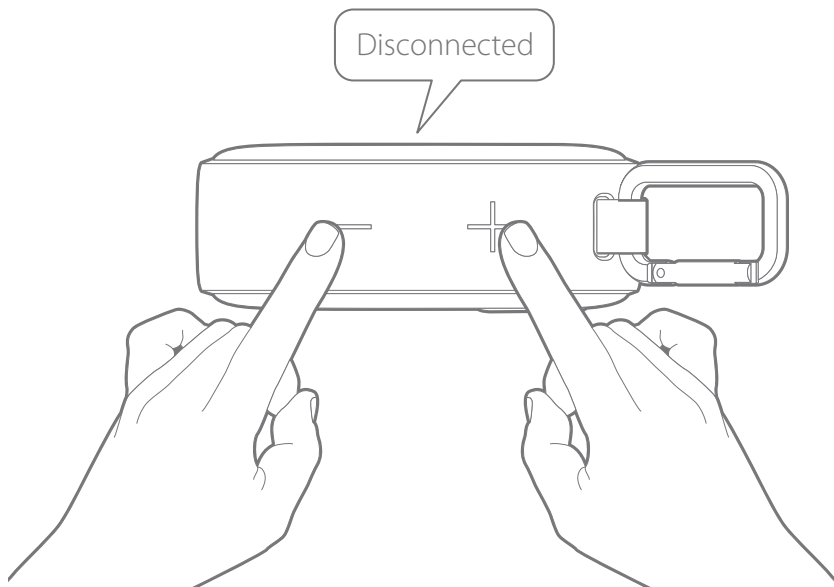

## SPEAKER PLACEMENT

Place the speaker as shown below, on a flat and stable surface.

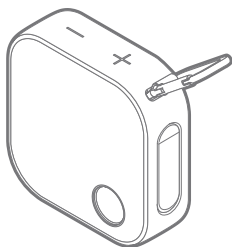

Correct

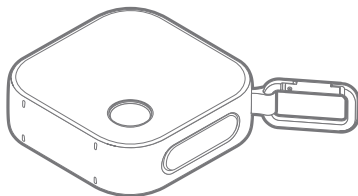

Incorrect

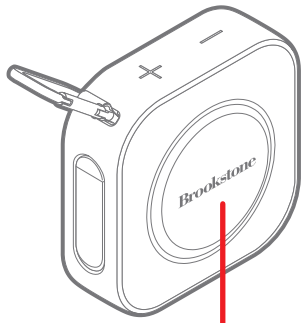

Passive radiator

**Note:** The passive radiator produces powerful bass which may cause the speaker to vibrate when playing songs with lots of bass at the speaker's highest volume level. If that occurs, try changing the location of the speaker or place it on a different type of surface.

## AUDIO CONTROL

- Touch the Power button to pause or resume audio playback.
- Press the + button to increase volume.
- Press the – button to decrease volume.
- Press and **HOLD** the + button to skip to the next track.
- Press and **HOLD** the – button to go back to the previous track.

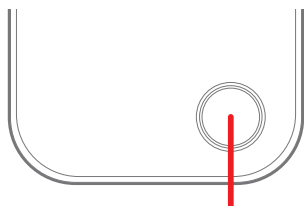

Power button

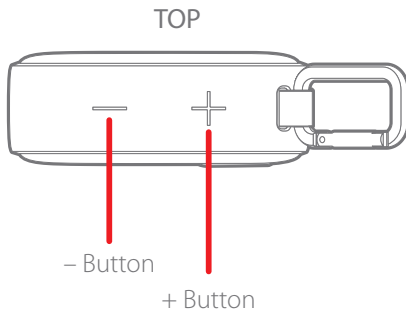



## PHONE CALLS

- Touch the Power button to answer an incoming phone call or end a call.

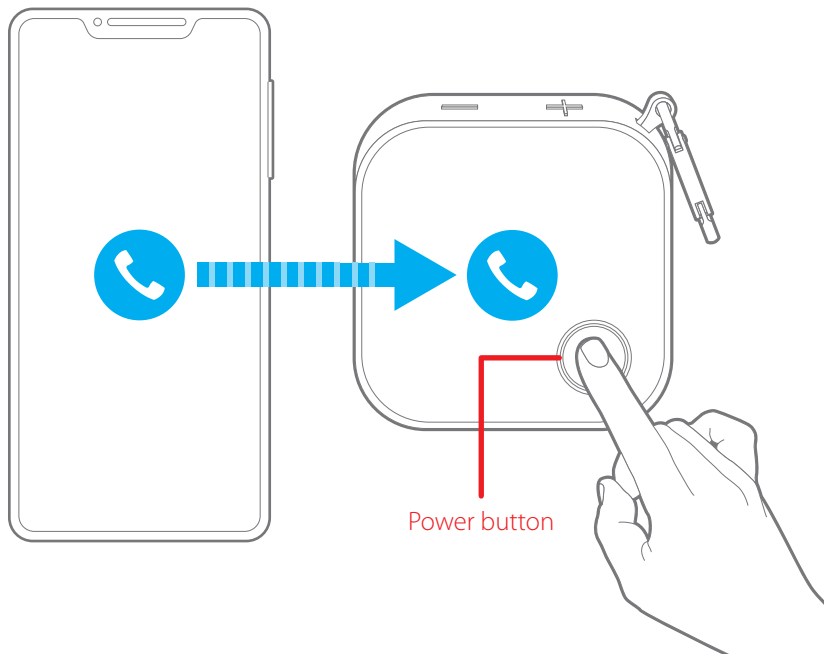

## **WATERPROOF RATING – IPX7**

- This speaker has an ingress protection rating of 7 (IPX7). This means it can be completely submerged in water for up to 30 minutes at a depth of 1 meter.
- The protective rubber seal needs to completely cover the speaker's input panel to protect it from water damage.
- Dry the speaker off completely before charging or using the AUX inputs.
- Do NOT charge near sources of water or wet areas.

## **BEFORE EXPOSING TO WATER:**

- REMOVE ALL CABLES CONNECTED TO THE SPEAKER
- MAKE SURE THE PORTS COVER IS SEALED TIGHTLY
- DO NOT EXPOSE TO WATER WHILE CHARGING

## FCC INFORMATION

This device complies with Part 15 of the FCC Rules. Operation is subject to the following two conditions:

- (1) this device may not cause harmful interference, and
- (2) this device must accept any interference received, including interference that may cause undesired operation.

**Warning:** Changes or modifications to this unit not expressly approved by the party responsible for compliance could void the user's authority to operate the equipment.

**NOTE:** This equipment has been tested and found to comply with the limits for a Class B digital device, pursuant to Part 15 of the FCC Rules. These limits are designed to provide reasonable protection against harmful interference in a residential installation. This equipment generates, uses and can radiate radio frequency energy and, if not installed and used in accordance with the instructions, may cause harmful interference to radio communications. However, there is no guarantee that interference will not occur in a particular installation. If this equipment does cause harmful interference to radio or television reception, which can be determined by turning the equipment off and on, the user is encouraged to try to correct the interference by one or more of the following measures:

- Reorient or relocate the receiving antenna.
- Increase the separation between the equipment and receiver.
- Connect the equipment into an outlet on a circuit different from that to which the receiver is connected.
- Consult the dealer or an experienced radio/TV technician for help

### Information Regarding Exposure to Radio Frequency Energy

Your device is designed and manufactured not to exceed the emission limits for exposure to RF energy set by the Federal Communications Commission of the United States (FCC). Information on your Device is on file with the FCC and can be found under the Display Grant section of <http://www.fcc.gov/oet/ea/> after searching on the FCC ID for your Device, which can be found on the back of the Device.

## IC INFORMATION

This device complies with Industry Canada license-exempt RSS standard(s).  
Operation is subject to the following two conditions:

- (1) This device may not cause interference, and
- (2) This device must accept any interference, including interference that may cause undesired operation of the device.

This equipment complies with IC radiation exposure limits set forth for an uncontrolled environment. End user must follow the specific operating instructions for satisfying RF exposure compliance. This transmitter must not be co-located or operating in conjunction with any other antenna or transmitter.

These requirements set a SAR limit of 1.6 W/kg averaged over one gram of tissue. The highest SAR value for this model phone when tested for use at the ear is 0.532 W/Kg and when worn on the body is 1.054 W/Kg. This device was tested for typical body-worn operations. To comply with RF exposure requirements, a minimum separation distance of 10mm must be maintained between the user's body and the handset, including the antenna. Third-party belt-clips, holsters, and similar accessories used by this device should not contain any metallic components. Body-worn accessories that do not meet these requirements may not comply with RF exposure requirements and should be avoided. Use only the supplied or an approved antenna.

### LITHIUM POLYMER BATTERY WARNINGS

This device contains a non-removable Lithium-Polymer battery. The battery must be recycled or disposed of properly. Contact your local waste management office for information on battery recycling or disposal.



## Rating Label Definitions



Direct current symbol.



This symbol signifies the product must not be discarded as household waste, and should be delivered to an appropriate collection facility for recycling. Proper disposal and recycling helps protect natural resources, human health and the environment.



This symbol signifies and declares that this equipment has battery charging which complies with California CEC and energy efficiency.



This symbol signifies that this is a wireless device powered by Bluetooth® technology. The Bluetooth® word mark and logos are registered trademarks owned by Bluetooth SIG, Inc., used under license.

# LIMITED WARRANTY

## 1-Year Limited Warranty

Territory: United States/Canada

### LIMITED WARRANTY TO ORIGINAL CONSUMER

This product (including any accessories included in the original packaging) as supplied and distributed new by an authorized retailer is warranted by Southern Telecom, Inc. to the original consumer purchaser against defects in materials and workmanship ("Warranty") as follows:

#### To obtain warranty service:

Visit our website at [www.southerntelecom.com](http://www.southerntelecom.com)

Click on **Product Support**

Select the **Brand** of your device

Select **Service Request** and fill out the form to begin your inquiry

Your product will be repaired or replaced, at our option, for the same or similar model of equal value if examination by the service center determines this product is defective. Products received damaged as a result of shipping will require you to file a claim with the carrier.

#### Warranty service not provided

This warranty does not cover damage resulting from accident, misuse, abuse, improper installation or operation, lack of reasonable care, unauthorized modification including software modifications such as the installation of custom firmware. This warranty is voided in the event any unauthorized person opens, alters or repairs this product. All products being returned to the authorized service center for repair must be suitably packaged.

NO WARRANTIES, WHETHER EXPRESS OR IMPLIED, INCLUDING, BUT NOT LIMITED TO, ANY IMPLIED WARRANTIES OF MERCHANTABILITY OR FITNESS FOR A PARTICULAR PURPOSE, OTHER THAN THOSE EXPRESSLY DESCRIBED ABOVE SHALL APPLY. DISTRIBUTOR FURTHER DISCLAIMS ALL WARRANTIES AFTER THE EXPRESS WARRANTY PERIOD STATED ABOVE. NO OTHER EXPRESS WARRANTY OR GUARANTY GIVEN BY ANY PERSON, FIRM OR ENTITY WITH

RESPECT TO THE PRODUCT SHALL BE BINDING ON DISTRIBUTOR. REPAIR, REPLACEMENT, OR REFUND OF THE ORIGINAL PURCHASE PRICE - AT DISTRIBUTOR'S SOLE DISCRETION - ARE THE EXCLUSIVE REMEDIES OF THE CONSUMER. IN NO EVENT WILL DISTRIBUTOR OR ITS MANUFACTURERS BE LIABLE FOR ANY INCIDENTAL, DIRECT, INDIRECT, SPECIAL, PUNITIVE OR CONSEQUENTIAL DAMAGES (SUCH AS, BUT NOT LIMITED TO, DAMAGES FOR LOSS OF PROFITS, BUSINESS, SAVINGS, DATA OR RECORDS) CAUSED BY THE USE, MISUSE OR INABILITY TO USE THE PRODUCT. EXCEPT AS STATED HEREIN, NO OTHER WARRANTIES SHALL APPLY. NOTWITHSTANDING THE FOREGOING, CONSUMER'S RECOVERY AGAINST DISTRIBUTOR SHALL NOT EXCEED THE PURCHASE PRICE OF THE PRODUCT SOLD BY DISTRIBUTOR. THIS WARRANTY SHALL NOT EXTEND TO ANYONE OTHER THAN THE ORIGINAL CONSUMER WHO PURCHASED THE PRODUCT AND IS NOT TRANSFERABLE.

Some countries, states or provinces do not allow the exclusion or limitation of incidental or consequential damages or allow limitations on warranties, so limitation or exclusions may not apply to you. This warranty gives you specific legal rights, and you may have other rights that vary from state to state or province to province. Contact your authorized retailer to determine if another warranty applies.

All product names, trademarks, and registered trademarks are property of their respective owners. All company, product, and service names used in this document are for identification purposes only. Use of these names, trademarks, and brands does not imply endorsement.

Brookstone® trademark, name and logos are trademarks of BKST Brand Holdings LLC and used under license. Manufactured and Marked by Southern Telecom, Inc. under license.

Southern Telecom, Inc. 5601 1st Avenue Brooklyn, NY 11220

Model: BKS380

Printed in China

v1.0 08-2020

**Brookstone®**