

### Using Night Vision

You can use the infrared sensors on the front of the camera to take pictures or record video in the dark.

In either mode, press and hold the **[Power]** button for 2 seconds to enable or disable night vision. The LED indicator on the top of the camera will **briefly blink RED**.

### Using Motion Detection

In video standby mode, press and hold the **[Mode]** button for 3 seconds. Next to the solid blue light, the LED indicator will **blink RED** 4 times and then turn OFF. The camera is now in motion detection mode.

To exit motion detection mode, press any button.

### Resetting the Camera

If you experience any problems with the camera, you can reset it back to factory settings using the Reset Port.

To reset, stick a small, sharp object into the Reset Port on the side of the camera, and press.

### Using the Clip

Snap the camera into the holder attached to the included clip.

### Using the Wall Bracket

1. Select a location to install the wall bracket.
2. Screw or hammer 2 small screws or nails through the holes in the wall bracket into the wall.
3. Place the camera in the wall bracket's clasp. Adjust the camera in the clasp as needed.

### Accessing Photos & Videos

Connect the included micro SD/TF card to your computer. You may need to use a micro SD/TF card adapter (*not included*).

Open the folder of the card after it shows up as an external device on your computer. You should be able to access the photos and videos and that you have taken with the camera.

If you have issues accessing the files, consult your computer or micro SD/TF card adapter manufacturer's instructions.

## Compliance Information

### FCC Information

This device complies with Part 15 of the FCC Rules.

**Caution:** Any changes or modifications not expressly approved could void the user's authority to operate the equipment.

**Note:** This equipment has been tested and found to comply with the limits for a Class B digital device, pursuant to part 15 of the FCC Rules. These limits are designed to provide reasonable protection against harmful interference in a residential installation. This equipment generates, uses and can radiate radio frequency energy and, if not installed and used in accordance with the instructions, may cause harmful interference to radio communications. However, there is no guarantee that interference will not occur in a particular installation. If this equipment does cause harmful interference to radio or television reception, which can be determined by turning the equipment off and on, the user is encouraged to try to correct the interference by one or more of the following measures:

- Reorient or relocate the receiving antenna.
- Increase the separation between the equipment and receiver.
- Connect the equipment into an outlet on a circuit different from that to which the receiver is connected.
- Consult the dealer or an experienced radio/TV technician for help.

This device complies with Part 15 of the FCC Rules. Operation is subject to the following two conditions: (1) This device may not cause harmful interference, and (2) this device must accept any interference received, including interference that may cause undesired operation.

### Radiation Exposure Information

The device has been evaluated to meet general RF exposure requirement. The device can be used in portable exposure condition without restriction.

### WARNING Li-Ion Battery Inside

This product is fitted with a Li-Ion battery. Do not damage, open, or dismantle the battery and do not use in damp and/or corrosive conditions. Use only with compatible chargers. Never dispose of batteries in a fire, and never expose them to high temperatures. Do not expose the product to temperatures exceeding 60°C (140°F).

### Rating Label Definitions

⎓ Direct current symbol.



This symbol signifies the product must not be discarded as household waste, and should be delivered to an appropriate collection facility for recycling. Proper disposal and recycling helps protect natural resources, human health and the environment.



This symbol signifies and declares that this equipment has battery charging which complies with California CEC and energy efficiency.



This symbol represents FCC Declaration of Conformity and compliance.



## Warranty Information

### 90-day Limited Warranty

Territory: United States/Canada

### LIMITED WARRANTY TO ORIGINAL CONSUMER

This product (including any accessories included in the original packaging) as supplied and distributed new by an authorized retailer is warranted by Southern Telecom, Inc. to the original consumer purchaser against defects in materials and workmanship ("Warranty") as follows:

### To obtain warranty service:

- Visit our website at [www.southerntelecom.com](http://www.southerntelecom.com)
- Click on **Product Support**
- Select the **Brand** of your device
- Select **Service Request** and fill out the form to begin your inquiry

Your product will be repaired or replaced, at our option, for the same or similar model of equal value if examination by the service center determines this product is defective. Products received damaged as a result of shipping will require you to file a claim with the carrier.

### Warranty service not provided

This warranty does not cover damage resulting from accident, misuse, abuse, improper installation or operation, lack of reasonable care, unauthorized modification including software modifications such as the installation of custom firmware. This warranty is voided in the event any unauthorized person opens, alters or repairs this product. All products being returned to the authorized service center for repair must be suitably packaged.

NO WARRANTIES, WHETHER EXPRESS OR IMPLIED, INCLUDING, BUT NOT LIMITED TO, ANY IMPLIED WARRANTIES OF MERCHANTABILITY OR FITNESS FOR A PARTICULAR PURPOSE, OTHER THAN THOSE EXPRESSLY DESCRIBED ABOVE SHALL APPLY. DISTRIBUTOR FURTHER DISCLAIMS ALL WARRANTIES AFTER THE EXPRESS WARRANTY PERIOD STATED ABOVE. NO OTHER EXPRESS WARRANTY OR GUARANTEE GIVEN BY ANY PERSON, FIRM OR ENTITY WITH RESPECT TO THE PRODUCT SHALL BE BINDING ON DISTRIBUTOR. REPAIR, REPLACEMENT, OR REFUND OF THE ORIGINAL PURCHASE PRICE - AT DISTRIBUTOR'S SOLE DISCRETION - ARE THE EXCLUSIVE REMEDIES OF THE CONSUMER. IN NO EVENT WILL DISTRIBUTOR OR ITS MANUFACTURERS BE LIABLE FOR ANY INCIDENTAL, DIRECT, INDIRECT, SPECIAL, PUNITIVE OR CONSEQUENTIAL DAMAGES (SUCH AS, BUT NOT LIMITED TO, DAMAGES FOR LOSS OF PROFITS, BUSINESS, SAVINGS, DATA OR RECORDS) CAUSED BY THE USE, MISUSE OR INABILITY TO USE THE PRODUCT, EXCEPT AS STATED HEREIN. NO OTHER WARRANTIES SHALL APPLY, NOTWITHSTANDING THE FOREGOING, CONSUMER'S RECOVERY AGAINST DISTRIBUTOR SHALL NOT EXCEED THE PURCHASE PRICE OF THE PRODUCT SOLD BY DISTRIBUTOR. THIS WARRANTY SHALL NOT EXTEND TO ANYONE OTHER THAN THE ORIGINAL CONSUMER WHO PURCHASED THE PRODUCT AND IS NOT TRANSFERABLE.

Some countries, states or provinces do not allow the exclusion or limitation of incidental or consequential damages or allow limitations on warranties, so limitation or exclusions may not apply to you. This warranty gives you specific legal rights, and you may have other rights that vary from state to state or province to province. Contact your authorized retailer to determine if another warranty applies.

**All product names, trademarks, and registered trademarks are property of their respective owners. All company, product, and service names used in this document are for identification purposes only. Use of these names, trademarks, and brands does not imply endorsement.**

Printed in China  
v1. 07-2019

# invisi CAM

MINI SECURITY CAMERA



## Instruction Manual

ASQTV52SPY

## Before You Begin

### Customer Support

For any questions or problems with your product, please visit our website at [SouthernTelecom.com](http://SouthernTelecom.com) and click on **Product Support**.

### Caution

To ensure safe and proper use, read all safety information before using the device. Only use with manufacturer-approved batteries, chargers, accessories, and supplies.

- **THIS DEVICE IS NOT A TOY**, do NOT allow children or pets to use or play with this device.
- Do not disassemble, modify, or repair the device.
- Do not expose to extreme temperatures (heat or cold), open flames, humid, or wet conditions.
- Do not submerge in water.
- Do not overcharge battery.
- If using with a USB adapter, make sure the adapter is not damaged.
- Do not allow the USB port or the connectors of the supplied USB cable to be exposed to dust or water, or to come into contact with any conductive materials such as liquids, metallic powders, etc.

### In the Box

- ASOTV52SPY - Camera (x1)
- Charging Cable (x1)
- 8 GB Micro SD Card
- Wall Bracket (x1)
- Clip (x1)
- Instruction Manual (x1)

## Location of Controls

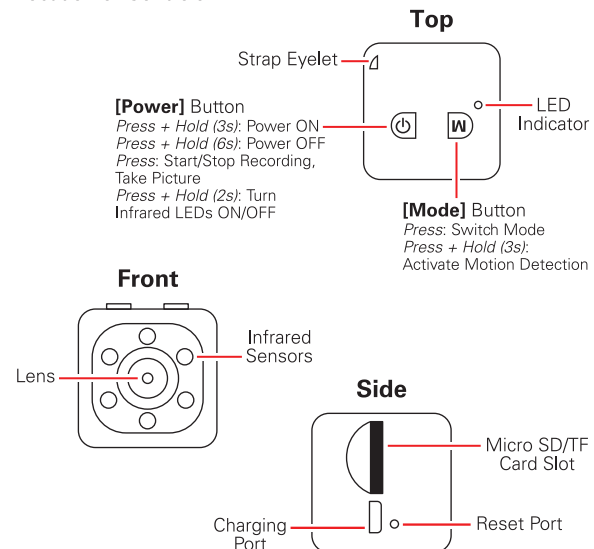

## Getting Started

### Charging the Camera

The camera can be used while charging.

Plug the small connector of the included charging cable into the charging port on the side of the camera. Plug the large connector into a USB power port, a portable USB charging device, or a compatible **5V USB adapter** (not included) and plug into a wall socket.

The LED indicator on the top of the camera will **turn solid RED** while connected to power.

When the camera runs out of battery or the storage card is full, the camera's LED indicator will **flash RED and BLUE** 5 times, and the camera will automatically save and power OFF.

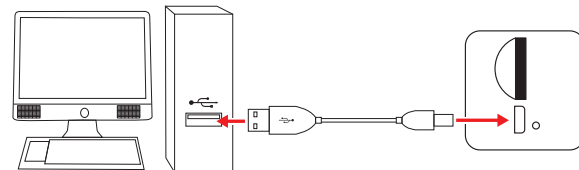

### Installing a Micro SD/TF Card

**Note:** The SD card only fits in one direction. Please make sure you are inserting the card in the right direction.

Push the micro SD/TF card into the micro SD/TF card slot on the side of the camera.

The ASOTV52SPY camera can take micro SD/TF cards up to 32 GB.

### Using the Camera

Charge the camera and install a micro SD/TF card before using. The camera **must** have a micro SD/TF card inserted to function properly. See the **Charging the Camera** and **Installing a Micro SD/TF Card** sections of this manual for instruction.

### Powering ON/OFF

- Press and hold the [Power] button for 3 seconds to power ON. The camera will power on in video mode, and the LED indicator will light up **solid BLUE**.
- Press and hold the [Power] button for 6 seconds to power OFF. The LED indicator will **briefly flash BLUE** and then turn off.
- The camera will automatically power OFF after 60 seconds to preserve battery life.

### Switching Modes

Press the [Mode] button on the top of the camera to switch between Video mode and Picture mode. The LED indicator will show **solid BLUE** when in Video mode on standby, and **solid RED** when in Picture mode.

### Recording Video

Power the camera ON. The camera will be on standby in Video mode by default.

- Press the [Power] button to start video recording. The LED indicator will **flash 3 times and turn OFF**. The camera is recording video.
- Press the [Power] button again to stop recording. The camera will automatically save the video and return to Video standby mode. The LED indicator will **turn solid BLUE** to indicate the camera is back on standby.

### Taking Pictures

Power the camera ON and switch to Picture mode. The LED indicator will turn **solid RED**.

- Press the [Power] button to take a picture. The LED indicator will **blink once** to indicate that the camera has taken a picture.

