

USB and TF Card Input

Insert a USB device or TF card into the USB or TF card input ports on the back of the speaker. Both will only fit correctly in one direction.

Note: To listen to music on your USB device, you may need to have files stored in the root folder of the device. Check your USB device's manufacturer information for more details.

Press the [MODE/LED] button until you enter USB or TF card mode. A voice will be heard indicating the mode, and the speaker will automatically begin playing music off the device.

In USB and TF card mode, playback and volume adjustment will be controlled with controls on the back of the speaker.

- Press the [▶|/MIC VOL+] and [◀|/MIC VOL-] buttons to skip tracks.
- Pause and resume playback using the [⏸] button.

Using the Microphone

Plug the attached connector of the included microphone into the microphone input port on the back of the speaker. Switch the mic ON.

- Press and hold the [▶|/MIC VOL+] and [◀|/MIC VOL-] buttons to adjust microphone volume.
- Use the [VOLUME/POWER] dial to adjust overall volume.

Note: In order to avoid loud feedback, keep the microphone behind the speaker and pointed away from the speaker, and switch the microphone off when not in use.

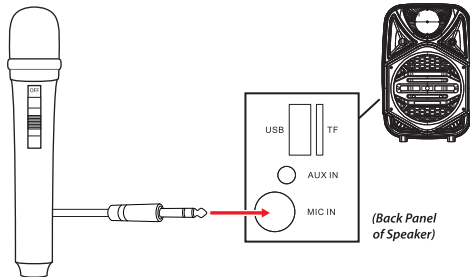

Compliance Information

FCC Information

This device complies with Part 15 of the FCC Rules.

Caution: Any changes or modifications not expressly approved could void the user's authority to operate the equipment.

Note: This equipment has been tested and found to comply with the limits for a Class B digital device, pursuant to part 15 of the FCC Rules. These limits are designed to provide reasonable protection against harmful interference in a residential installation. This equipment generates, uses and can radiate radio frequency energy and, if not installed and used in accordance with the instructions, may cause harmful interference to radio communications. However, there is no guarantee that interference will not occur in a particular installation. If this equipment does cause harmful interference to radio or television reception, which can be determined by turning the equipment off and on, the user is encouraged to try to correct the interference by one or more of the following measures:

- Reorient or relocate the receiving antenna.
- Increase the separation between the equipment and receiver.
- Connect the equipment into an outlet on a circuit different from that to which the receiver is connected.
- Consult the dealer or an experienced radio/TV technician for help.

This device complies with Part 15 of the FCC Rules. Operation is subject to the following two conditions: (1) This device may not cause harmful interference, and (2) this device must accept any interference received, including interference that may cause undesired operation.

WARNING Li-Ion Battery Inside

This product is fitted with a Li-ion battery. Do not damage, open, or dismantle the battery and do not use it in damp and/or corrosive conditions. Use only with compatible chargers. Never dispose of batteries in a fire, and never expose them to high temperatures. Do not expose the product to temperatures exceeding 60°C (140°F).



Radiation Exposure Information

This device has been evaluated to meet general RF exposure requirements. The device can be used in portable exposure conditions without restriction.

Rating Label Definitions

— Direct current



This symbol signifies that the product must not be discarded as household waste, and should be delivered to an appropriate collection facility for recycling. Proper disposal and recycling helps protect natural resources, human health and the environment.



This symbol signifies and declares that this equipment complies with battery charging which complies with California CEC and energy efficiency.



This symbol signifies that this is a wireless device powered by Bluetooth® technology. The Bluetooth® word mark and logos are registered trademarks owned by the Bluetooth SIG, Inc. and any use of such marks by Southern Telecom is under license.

Warranty Information

90-Day Limited Warranty

Territory: United States/Canada

LIMITED WARRANTY TO ORIGINAL CONSUMER

This product as supplied and distributed new by an authorized retailer is warranted by Southern Telecom, Inc. to the original consumer purchaser against defects in materials and workmanship ("Warranty") as follows:

To obtain warranty service:

- Visit our customer support portal: www.customersupport123.com
- Select the brand and model of your device
- Select "Service Request" and fill out the form to begin your inquiry
- Exchanges require dated proof of purchase from an authorized retailer

Your product will be repaired or replaced, at our option, for the same or similar model of equal value if examination by the service center determines this product is defective. Products received damaged as a result of shipping will require you to file a claim with the carrier.

Warranty service not provided

This warranty does not cover damage resulting from accident, misuse, abuse, improper installation or operation, lack of reasonable care, unauthorized modification including software modifications such as the installation of custom firmware. This warranty is voided in the event any unauthorized person opens, alters or repairs this product. All products being returned to the authorized service center for repair must be suitably packaged.

NO WARRANTIES, WHETHER EXPRESS OR IMPLIED, INCLUDING, BUT NOT LIMITED TO, ANY IMPLIED WARRANTIES OF MERCHANTABILITY OR FITNESS FOR A PARTICULAR PURPOSE, OTHER THAN THOSE EXPRESSLY DESCRIBED ABOVE SHALL APPLY. DISTRIBUTOR FURTHER DISCLAIMS ALL WARRANTIES AFTER THE EXPRESS WARRANTY PERIOD STATED ABOVE. NO OTHER EXPRESS WARRANTY OR GUARANTY GIVEN BY ANY PERSON, FIRM OR ENTITY WITH RESPECT TO THE PRODUCT SHALL BE BINDING ON DISTRIBUTOR, REPAIR, REPLACEMENT, OR REFUND OF THE ORIGINAL PURCHASE PRICE - AT DISTRIBUTOR'S SOLE DISCRETION - ARE THE EXCLUSIVE REMEDIES OF THE CONSUMER. IN NO EVENT WILL DISTRIBUTOR OR ITS MANUFACTURERS BE LIABLE FOR ANY INCIDENTAL, DIRECT, INDIRECT, SPECIAL, PUNITIVE OR CONSEQUENTIAL DAMAGES (SUCH AS, BUT NOT LIMITED TO, DAMAGES FOR LOSS OF PROFITS, BUSINESS, SAVINGS, DATA OR RECORDS) CAUSED BY THE USE, MISUSE OR INABILITY TO USE THE PRODUCT. EXCEPT AS STATED HEREIN, NO OTHER WARRANTIES SHALL APPLY. NOTWITHSTANDING THE FOREGOING, CONSUMER'S RECOVERY AGAINST DISTRIBUTOR SHALL NOT EXCEED THE PURCHASE PRICE OF THE PRODUCT SOLD BY DISTRIBUTOR. THIS WARRANTY SHALL NOT EXTEND TO ANYONE OTHER THAN THE ORIGINAL CONSUMER WHO PURCHASED THE PRODUCT AND IS NOT TRANSFERABLE.

Some countries, states or provinces do not allow the exclusion or limitation of incidental or consequential damages or allow limitations on warranties, so limitation or exclusions may not apply to you. This warranty gives you specific legal rights, and you may have other rights that vary from state to state or province to province. Contact your authorized retailer to determine if another warranty applies.

All product names, trademarks, and registered trademarks are property of their respective owners. All company, product, and service names used in this document are for identification purposes only. Use of these names, trademarks, and brands does not imply endorsement.

Printed in China
Designed in USA
v1. 08-2021

ART+SOUND™

EXPEDITION Karaoke Party Speaker & Microphone



Instruction Manual AR1999

Before You Begin...

READ THIS MANUAL AND SAVE FOR FUTURE REFERENCE

Caution

To ensure safe and proper use, read all safety information before using the device. Only use with manufacturer-approved batteries, chargers, accessories, and supplies.

- **THIS DEVICE IS NOT A TOY**, do NOT allow children or pets to use or play with this device.
- Do not disassemble, modify, or repair the device. There are no user-serviceable parts.
- Do not expose the unit to extreme temperatures (heat or cold), open flames, humid, or wet conditions.
- **Do not submerge in water.**
- Low power may cause poor Bluetooth connection or sound distortion.
- Do not overcharge battery.
- If using with a USB adapter, make sure the adapter is not damaged.
- Do not allow the USB port or the connectors of the supplied USB cable to be exposed to dust, or water, or come into contact with any conductive materials such as liquids, metallic powders, etc.
- This device contains a built-in battery and should not be disposed of with regular household waste. Please consult the local authorities on the correct way to dispose of this device.

Questions & Customer Support

For any issues concerning this product, please visit our website at customersupport123.com and select the Brand of your product.

In the Box

- AR1999 - Wireless Speaker (x1)
- Karaoke Microphone (x1)
- USB Charging Cable (x1)
- Instruction Manual (x1)

Location of Controls

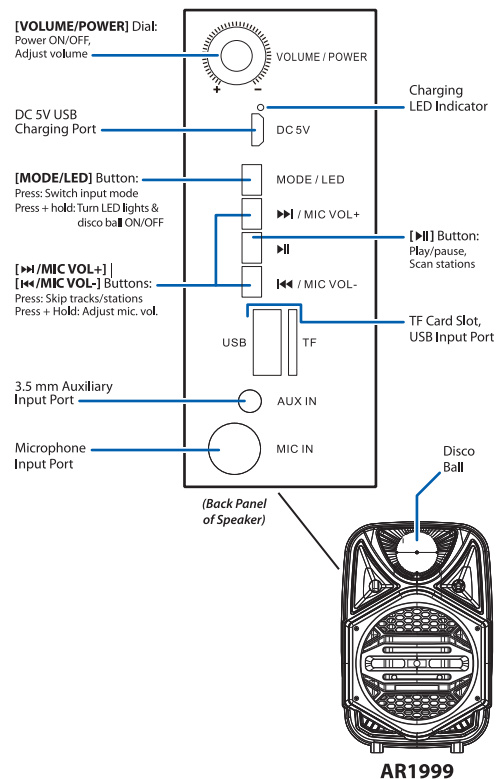

Getting Started

Charging the Speaker

Plug the small connector of a supplied micro-USB charging cable into the DC 5V USB charging port on the back panel of the speaker. Plug the large connector into the USB port on a computer or into a compatible **5V USB adapter** (not included) and plug into an electrical outlet.

The charging LED indicator on the back of the speaker will **turn RED** while charging and turn **OFF** when fully charged. On low power, a tone will be heard indicating that the speaker needs to be recharged.

Powering the Speaker ON/OFF

- Turn the **[VOLUME/POWER]** dial to the right until it clicks to power ON.

A tone and a voice will be heard, and the speaker's LED lights will turn on. The speaker will enter Bluetooth pairing mode, and the speaker will automatically re-pair to any nearby, previously-paired devices with Bluetooth enabled.

- Turn the **[VOLUME/POWER]** dial to the left until it clicks to power OFF.

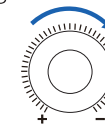

Adjusting Overall Volume

In any mode, overall volume can be adjusted with the controls on the back of the speaker. In AUX and Bluetooth mode, overall volume can also be adjusted by the controls on the connected device.

- Turn the **[VOLUME/POWER]** dial to adjust overall volume.

Using the Speaker Lights

The speaker's LED lights and disco ball lights will automatically turn on when the speaker is powered on.

Press and hold the **[MODE/LED]** button on the back of the speaker to power the LED lights and disco ball ON or OFF while using the speaker.

Switching Input Modes

Press the **[MODE/LED]** button on the back of the speaker to switch between input modes. A voice will be heard indicating the mode.

You must have a TF card or USB device inserted to switch to these modes.

Bluetooth Pairing

1. Power the speaker ON. A tone and voice will be heard indicating that the speaker is in Bluetooth pairing mode.
2. Set your mobile device to search for Bluetooth devices. When it appears, select **AR1999** from the list of found devices.
3. After a successful pairing, a voice will be heard and you will be able to play music on the speaker.

In Bluetooth mode, playback and volume can be controlled by your paired device or the controls on the back of the speaker.

- Pause and resume playback using the **[▶▶]** button.
- Press the **[▶▶/MIC VOL+]** and **[◀◀/MIC VOL-]** buttons to skip tracks.

Using the AUX Input

Insert one connector of a 3.5 mm auxiliary cable (not included) into the 3.5 mm auxiliary input jack on the back of the speaker. Insert the other connector into the headphone jack or audio output jack of your media-playing device.

Switch to AUX mode. A voice will be heard indicating the mode.

In AUX mode, media playback will be controlled by your connected device. Overall volume can be adjusted with the **[VOLUME/POWER]** dial on the speaker or with your connected device.

Using the FM Radio

Power the speaker ON and switch to FM mode.

All radio functions will be controlled by the buttons on the speaker.

- Press the **[▶▶]** button to start (or stop) automatically scanning and saving nearby available radio stations. If you do not stop the scan, the speaker will make a full scan of all available stations and return to the first station when finished.
- Press the **[▶▶/MIC VOL+]** and **[◀◀/MIC VOL-]** buttons to flip through saved stations.